

Throttle Control Cable Bracket

Adjustment

1. Disconnect the throttle control cable from the throttle control lever.
2. Bend down the lock tabs of the lock plate and remove the two 6 mm bolts to free the bracket.
3. Loosely install a new lock plate.
4. Position the special tool between the throttle control lever and the bracket as shown.

NOTE: The special tool is designed so that the distance between the lever and the bracket is 83.5 mm (3.287 in.) when it is installed.

5. Position the bracket so that there is no binding between the bracket and the special tool (tolerance 0 to +0.3 mm). Then tighten the two 6 mm bolts, bend up the lock plate tabs against the bolts heads.

CAUTION: Make sure the control lever doesn't get pulled toward the bracket side as you tighten the bolts.

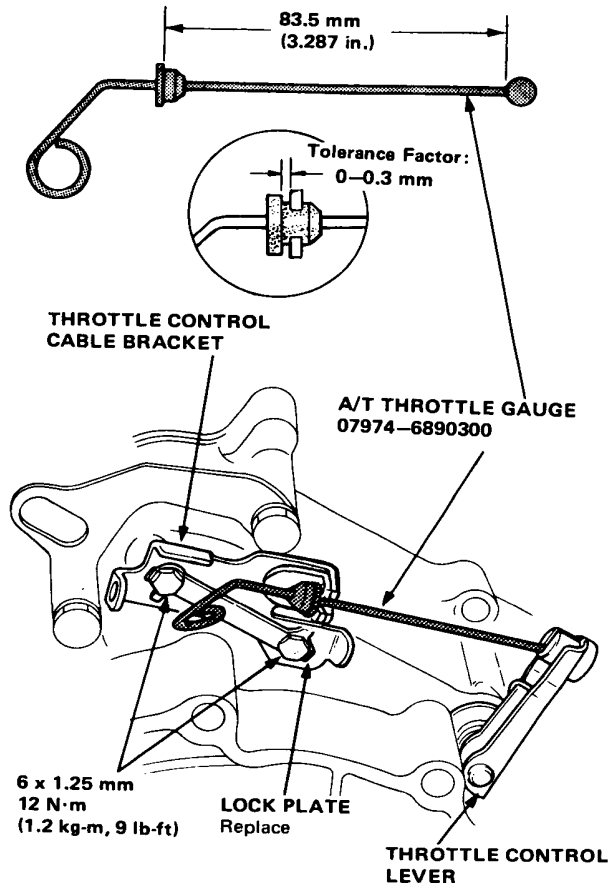

Throttle Control Cable

Adjustment/Inspection

NOTE: Perform the following inspections before adjusting the throttle control cable.

- The carburetor throttle cable play is correct. See Fuel section.
- The engine is warmed-up to operating temperature.

NOTE: The cooling fan should come on twice or more.

- The idle speed is correct. See Fuel section.
- The automatic choke operation is correct. See Fuel section.
- The distance between the throttle control lever and the throttle control bracket is correct as shown in left column.

1. With the engine off, disconnect the throttle control cable from the throttle control lever.
2. Disconnect the vacuum tube from the dash pot, connect the vacuum pump and keep vacuum applied. This simulates a normal operating amount of pull by the dash pot as if the engine were running.

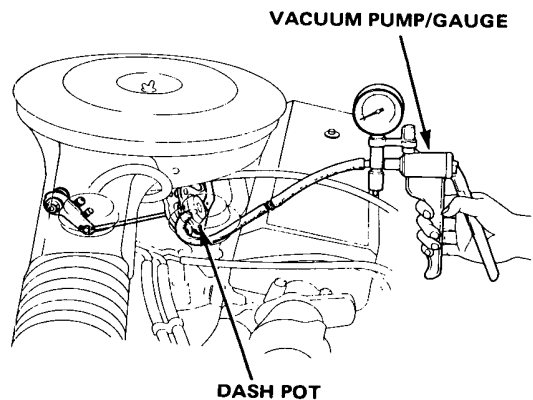



3. Attach a weight of about 1.3 kg (2.6 lbs) to the accelerator pedal. Raise the pedal, then release it, this will allow the weight to remove the normal free play from the throttle cable.

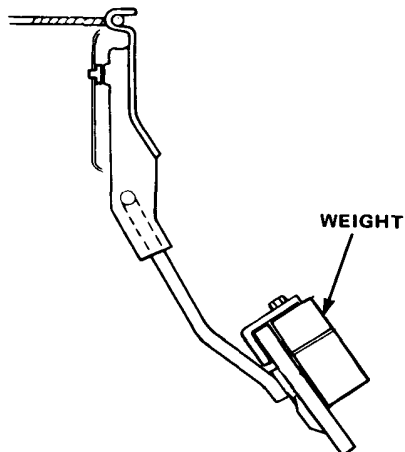

4. Secure the throttle control cable with clamps as shown.

L/H

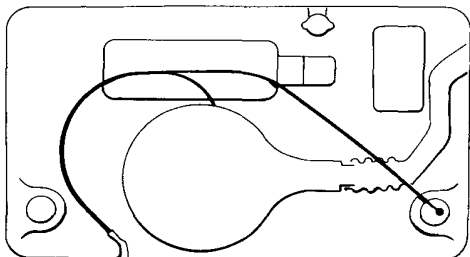

R/H

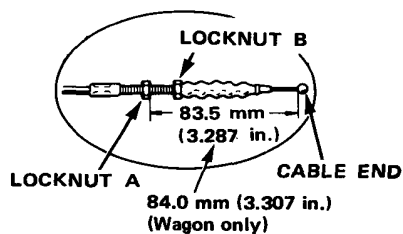
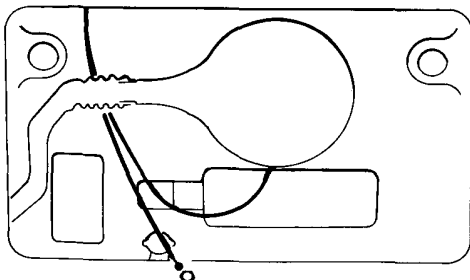

5. L/H: Lay the end of the throttle control cable on the R damper shock tower.
R/H: Lay the end of the throttle control cable on the engine hood latch.
6. Adjust the distance between the throttle control cable end and nut (A).
Hatchback and Sedan : 83.5 mm (3.287 in.)
Wagon : 84.0 mm (3.307 in.)
7. Insert the end of throttle control cable in the groove of the throttle control lever.

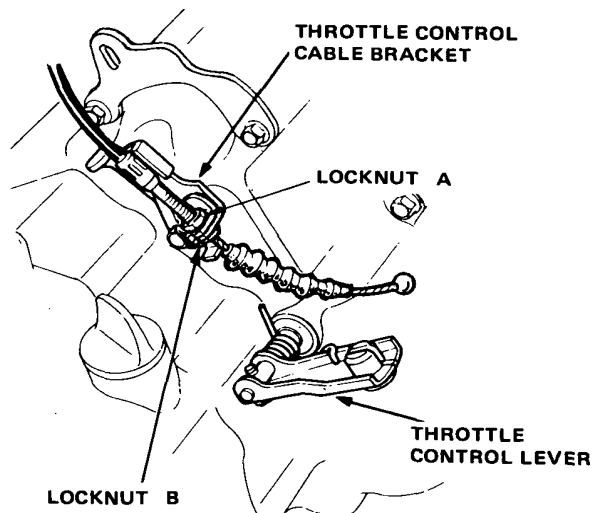

8. Insert the throttle control cable in the bracket and secure with lock nut (B).

NOTE: Make sure the cable is not kinked or twisted.

(cont'd)

Throttle Control Cable

Adjustment/Inspection (cont'd)

9. Check that the cable moves freely by depressing the accelerator.
10. Remove the weight on the accelerator pedal and push the pedal to make sure that there is the specified play at the throttle control lever.

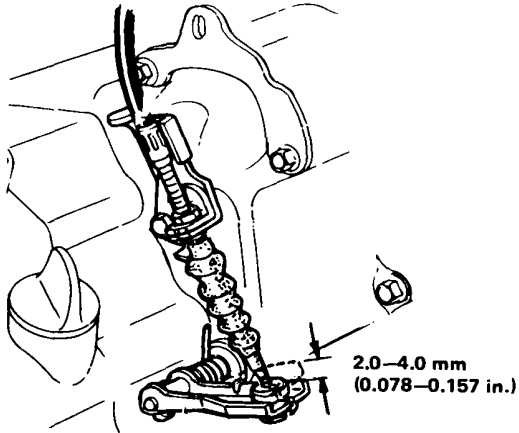

11. Start the engine and check the synchronization between the carburetor and the throttle control cable.

NOTE: The throttle control lever should start to move as engine speed increases.

- If the throttle control lever moves before engine speed increases, turn the cable lock nut A counterclockwise and re-tighten lock nut B.
- If the throttle control lever moves after engine speed increases, turn lock nut A clockwise and re-tighten the lock nut B.